

## 7200 Series

## Angular Contact Ball Bearings

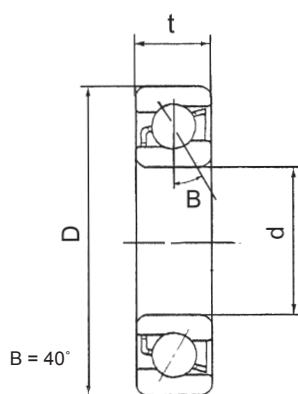

Ball / Roller Bearing

Bearing Number	Dimensions (mm)			Basic Load Ratings (N)		Limiting Speeds (rev/min)		Weight kg
	Bore d	OD D	Width t	$C_r$	$C_{or}$	Grease	Oil	
7200 B	10	30	9	7020	3350	19000	28000	0.030
7201 B	12	32	10	7610	3800	18000	26000	0.036
7202 B	15	35	11	8840	4800	17000	24000	0.045
7203 B	17	40	12	11100	6100	15000	20000	0.065
7204 B	20	47	14	14000	8300	12000	17000	0.110
7205 B	25	52	15	15600	10200	10000	15000	0.130
7206 B	30	62	16	23800	15600	8500	12000	0.200
7207 B	35	72	17	30700	20800	8000	11000	0.280
7208 B	40	80	18	36400	26000	7000	9500	0.370
7209 B	45	85	19	37700	28000	6700	9000	0.420
7210 B	50	90	20	39000	30500	6000	8000	0.470
7211 B	55	100	21	48800	38000	5600	7500	0.620
7212 B	60	110	22	57200	45500	5000	6700	0.800
7213 B	65	120	23	66300	54000	4500	6000	1.000
7214 B	70	125	24	71500	60000	4300	5600	1.100
7215 B	75	130	25	72800	64000	4300	5600	1.200
7216 B	80	140	26	83200	73500	3800	5000	1.450
7217 B	85	150	28	95600	83000	36000	4800	1.850
7218 B	90	160	30	10800	96500	3400	4500	2.300
7219 B	95	170	32	124000	108000	3200	4300	2.700
7220 B	100	180	34	135000	122000	3000	4000	3.300
7221 B	105	190	36	148000	137000	2800	3800	3.950
7222 B	120	200	38	163000	153000	2600	3600	4.600
7224 B	100	215	40	165000	163000	2200	3200	6.100

\*For Brass cage add, Suffix 'M'.

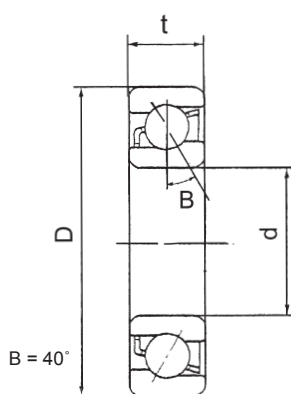

Bearing Number	Dimensions (mm)			Basic Load Ratings (N)		Limiting Speeds (rev/min)		Weight kg
	Bore d	OD D	Width t	<i>C<sub>r</sub></i>	<i>C<sub>or</sub></i>	Grease	Oil	
7302 B	15	42	13	13000	6700	15000	20000	0.08
7303 B	17	47	14	15900	8300	13000	18000	0.11
7304 B	20	52	15	19000	10400	11000	16000	0.14
7305 B	25	62	17	26000	15600	9000	13000	0.23
7306 B	30	72	19	34500	21200	8000	11000	0.34
7307 B	35	80	21	39000	24500	7500	10000	0.45
7308 B	40	90	23	49400	33500	6700	9000	0.63
7309 B	45	100	25	60500	41500	6000	8000	0.85
7310 B	50	110	27	74100	51000	5300	7000	1.10
7311 B	55	120	29	85200	60000	4800	6300	1.40
7312 B	60	130	31	95600	69500	4500	6000	1.75
7313 B	65	140	33	108000	80000	4300	5600	2.15
7314 B	70	150	35	119000	90000	3800	5000	2.65
7315 B	75	160	37	133000	106000	3600	4800	3.20
7316 B	80	170	39	143000	118000	3400	4500	3.80
7317 B	85	180	41	153000	132000	3200	4300	4.45
7318 B	90	190	43	165000	146000	3000	4000	5.20
7319 B	95	200	45	178000	163000	2800	3800	6.05
7320 B	100	215	47	203000	190000	2600	3600	7.50

\* For Brass cage, add Suffix 'M'.